

Tools required: Small phillips screwdriver

This installation instruction sheet describes how to install medical gas console outlets. Before beginning installation, completely read all the instructions.

Twist-Lock, Barrel Assembly Installation

To install a twist-lock, barrel assembly, follow these instructions (see figure 1 on page 1):

Figure 1. Twist-Lock, Barrel Assembly

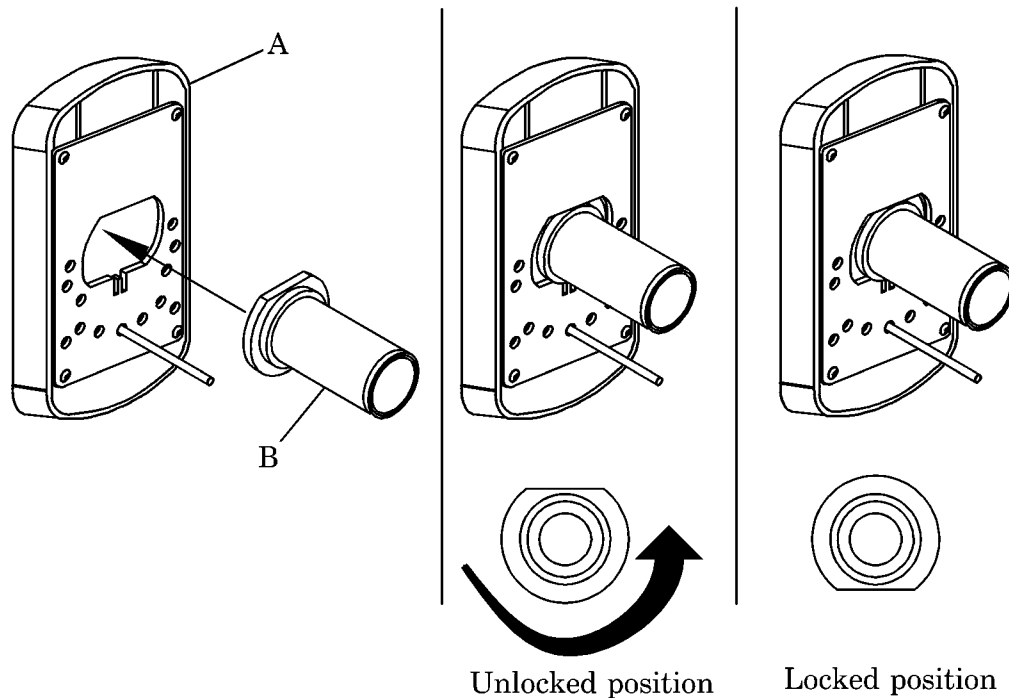

i294_004

WARNING:

Before installing the twist-lock, barrel assembly for medical vacuum, WAGD or AGSS inlets, turn off the gas service supply to the console. These inlets do not have secondary checks to prevent the line from maintaining a draw (suction). Failure to turn off the supply could cause personal injury or equipment damage.

- 1) If using this procedure to install a twist-lock, barrel assembly for medical vacuum, WAGD, or AGSS, turn off the gas service supply for the console outlets.

NOTE:

It is not necessary to turn off an outlet's pressurized, gas service supply before installing the twist-lock, barrel assembly. The secondary check valve in the rough-in assembly prevents gas flow for pressure gas services.

- 2) Tilt the twist-lock, barrel assembly (B) downward to install it.
- 3) Insert the twist-lock, barrel assembly (B) into the keying disc assembly (A).
- 4) Rotate the twist-lock, barrel assembly (B) counterclockwise 180°, until the flat part of the barrel assembly is at the 6:00 position.
- 5) Install the frontbody assembly (see "Frontbody Assembly Installation" on page 2).
- 6) Ensure the gas service supply is turned on.
- 7) Ensure the gas outlet does not leak.

Frontbody Assembly Installation

To install a frontbody assembly, follow these instructions (see figure 2 on page 3):

Figure 2. Frontbody Assembly

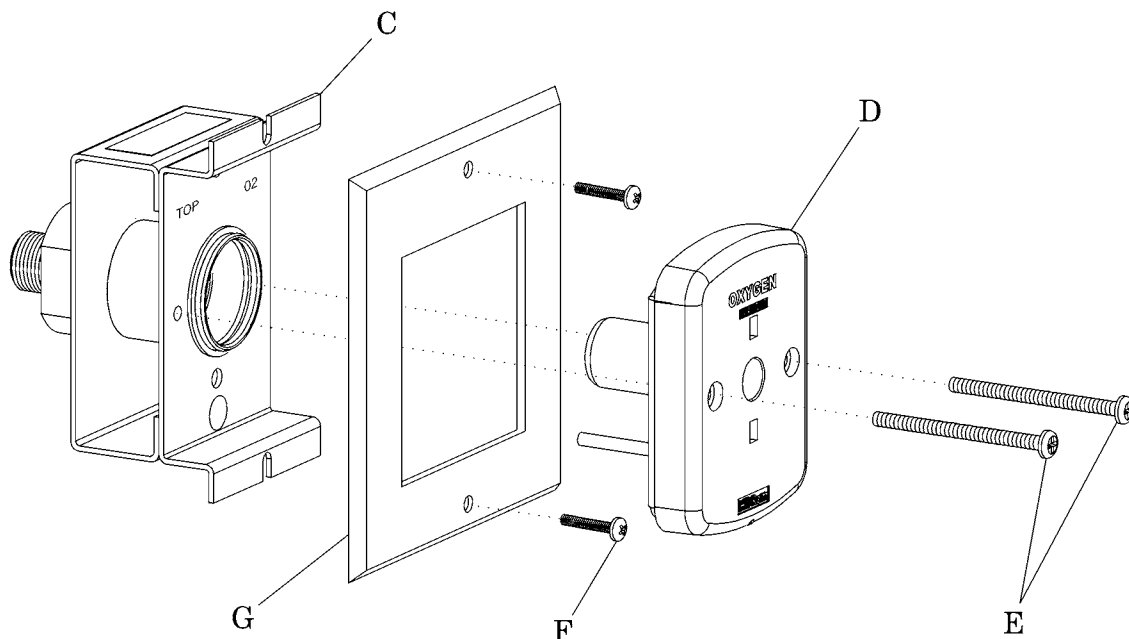

i294_001

WARNING:

Before installing the frontbody assembly for medical vacuum, Waste Anesthetic Gas Disposal (WAGD) or Anesthetic Gas Scavenging System (AGSS) inlets, turn off the gas service supply to the console. These inlets do not have secondary checks to prevent the line from maintaining a draw (suction). Failure to turn off the supply could cause personal injury or equipment damage.

- 1) If using this procedure to install a frontbody assembly for medical vacuum, WAGD, or AGSS, turn off the gas service supply for the console outlets.

NOTE:

It is not necessary to turn off an outlet's pressurized, gas service supply before installing the twist-lock, barrel assembly. The secondary check valve in the rough-in assembly prevents gas flow for pressure gas services.

- 2) Using a small phillips screwdriver, tighten the two screws (F) that secure the faceplate (G) to the rough-in assembly (C).
- 3) Align the frontbody assembly (D) with the rough-in assembly (C), ensuring that the locating pin aligns with the backbody unit.
- 4) Using a small phillips screwdriver, tighten the two screws (E) that secure the frontbody assembly (D) to the rough-in assembly (C).
- 5) Ensure the gas service supply is turned on.
- 6) Ensure the gas outlet does not leak.



Corporate Headquarters

BeaconMedæS
1800 Overview Drive
Rock Hill, SC 29730
Phone (803) 817-5600
Fax (803) 817-5750

**For technical support or
to place an order call:**

1 888 4 MEDGAS
(1-888-463-3427)
Fax (803) 817-5750
www.beaconmedaes.com