



SWG sterilizing grade glass fiber filters

High efficient filtration of gases in food, pharmaceutical and industrial applications

SWG filters provide reliable, efficient and validated sterilization of gases used in critical applications. Its filter media consists of hydrophobic glass fiber with support layers integrated into a stainless steel cage, core and end caps. It has an extended service life thanks to its robust construction and durable materials. The three dimensional borosilicate depth media offers low pressure drop and high flow rate capabilities. These are complemented by a large void volume for increased contaminant holding capacity.



Key features:

- High flow and low pressure drop
- Absolute retention rate (gas)
- Non fiber releasing
- High dust holding capacity
- High temperature and mechanical resistance

Applications:

- Compressed air and nitrogen
- Sterile venting of tanks
- Fermentation inlet gas and off-gas filtration
- Sterilization of compressed air

Qualifications:

- Manufacturing acc. ISO 9001
- Gasket material meets EU Regulation No. 1935/2004
- Materials used meet FDA title 21
- 100% integrity tested
- Full traceability

Protecting process, products and people

Atlas Copco's process filters optimize your productivity while protecting your process, product and consumers. Our portfolio of cartridges and housings covers all your filtration needs. The products are made from proven, high quality materials from reputable suppliers and manufactured in a controlled environment subjected to strict QA/QC procedures.



Product specifications

Materials of construction	
Filter media	Glass fiber borosilicate
Support	Polyester
Core/cage	SS304
End caps	SS304
Seal	EPDM, Fluoraz
Operating condition	
Minimum temperature	-20°C/-4°F
Maximum temperature	180°C/356°F (EPDM), 200°C/392°F (Fluoraz)
Maximum differential pressure (forward flow)	5.0 bar
Retention	
Particle removal efficiency 0,2 µm	99.99998 %
Bacterial retention	LRV >7/cm ² for viruses and phages
SIP/CIP	
Steam sterilization – in situ	121°C/250°F for 30 mins, 141°C/285°F for 10 mins
Steam sterilization - Autoclave	121°C/250°F for 30 mins, 141°C/285°F for 10 mins

Dimensions

Size	A mm	B mm	C Inch	D mm	Correction factor
SWG 0310	76	12	¾"	42	0,12
SWG 0410	104	12	¾"	42	0,17
SWG 0420	104	14	1"	52	0,19
SWG 0520	104	14	1"	52	0,19
SWG 0525	128	14	1"	62	0,32
SWG 0530	128	16	2"	86	0,46
SWG 0725	180	14	1"	62	0,47
SWG 0730	180	16	2"	86	0,68
SWG 1030	254	16	2"	86	1,00
SWG 1530	381	16	2"	86	1,55
SWG 2030	508	16	2"	86	2,10
SWG 3030	762	16	2"	86	3,28
SWG 3050	762	16	3"	140	5,89

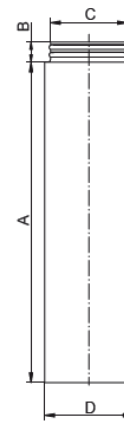

Flow rate

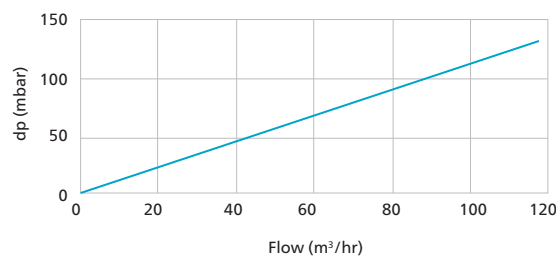

Note: 10" cartridge tested with air @ 20°C, 7 bar

Product configuration

Series	Rating	Length	End cap	Seal
SWG	0,2 µm	10" / 20" / 30"	UF	E=EPDM
		0310 / 0410	C7	F= Fluoraz
		0420 / 0520	C8	
		0525 / 0725		
		0730 / 1030		
		1530 / 2030		
		3030 / 3050		

Example: SWG 0,01µm 0730 UF E