



NGBV Series UL125, UL842 & CSA Listed Gas Shut-Off Valves

SPECIFICATION

Materials	
Body	ASTM B584 Bronze
Ball	ASTM B16 Brass, Chrome-Plated
Seat / Stem Packing	PTFE/ RPTFE
Stem / Gland & Retainer	ASTM B16
Handle / Nut	Steel, Zinc-Plated, Plastisol Grip

Technical Specifications	
Maximum Working Pressure	0.5 psig (ANSI Z21.15/ VGA 9.1) 5 PSIG (ASME B16.44)
Capacity (BTU/Hr.)	693,000 to 14,741,000 Depending on Valve Size
100% Factory Tested & Made in the USA	

Dimensions (inches)					
Size	A	B	C	D	E
1/2" F.NPT	1.11	2.25	1.68	3.85	2.27
3/4" F.NPT	1.26	2.67	1.93	3.85	2.72
1" F.NPT	1.65	3.42	2.19	4.78	3.18
1-1/4" F.NPT	1.87	3.86	2.37	4.78	3.56
1-1/2" F.NPT	2.05	4.22	2.81	5.40	4.21
2" F.NPT	2.48	5.02	3.18	5.40	4.93

A	
Size	Inscribe
1/2"	8
3/4"	12
1"	16
1-1/4"	20
1-1/2"	24
2"	32

B	
Inlet/Outlet Type	Inscribe
F.NPT Only	F

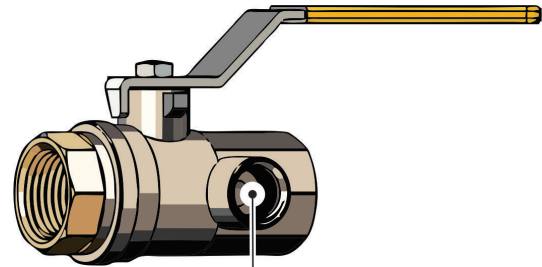

1/8" F.NPT Tapping Port
Shown Open But
Shipped with Pipe Plug Installed

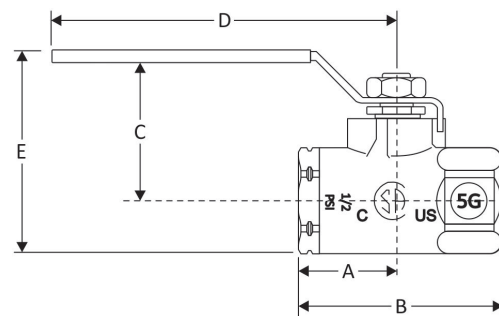

Ordering Information

NGBV - **- F -** **BZ -**
A B C D

C	
Material	Inscribe
ASTM B584 Bronze	BZ

D	
Options	Inscribe
Single Tap	ST
Double Tap ^[1]	DT
Lever Handle ^[2]	LH
Tee Handle	TH

^[1] Available for valves 3/4" & larger

^[2] Standard Lever