

# MVP1000 Series Modular Valve Panels

**APPLICATIONS**

<input checked="" type="checkbox"/>	Inert Gases
<input checked="" type="checkbox"/>	Oxidizing Gases
<input checked="" type="checkbox"/>	Flammable Gases
<input checked="" type="checkbox"/>	Corrosive Gases
<input checked="" type="checkbox"/>	Liquid Cylinder (Gas Delivery)
<input type="checkbox"/>	Cryogenic Liquid Delivery
<input type="checkbox"/>	General Purpose
<input checked="" type="checkbox"/>	High Purity
<input checked="" type="checkbox"/>	Ultra High Purity

**ON THE WEB**

<input checked="" type="checkbox"/>	Sell Sheet
<input checked="" type="checkbox"/>	Technical Brochure

**CALL US FOR**

<input checked="" type="checkbox"/>	2-D CAD Drawing
<input checked="" type="checkbox"/>	Engineering Specifications
<input checked="" type="checkbox"/>	Instruction Manual
<input checked="" type="checkbox"/>	Typical Installation Drawing

**Complete  
User-Defined  
System**

Inlet/Outlet Fitting  
(1/4" or 1/8" Compression)

Wide Selection of  
Flow meter

Lexan Sticker

Mounting Panel

Metering Valve  
(Optional)

Inlet/Outlet Fitting  
(1/4" or 1/8" Compression)

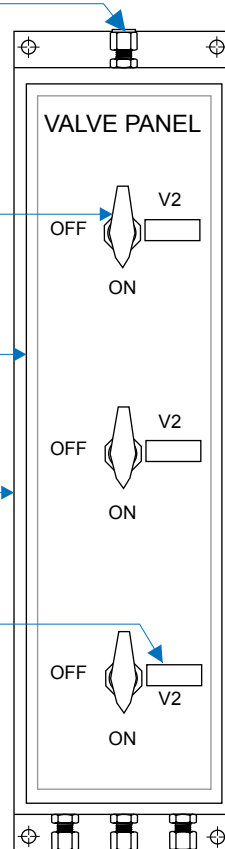

Front View

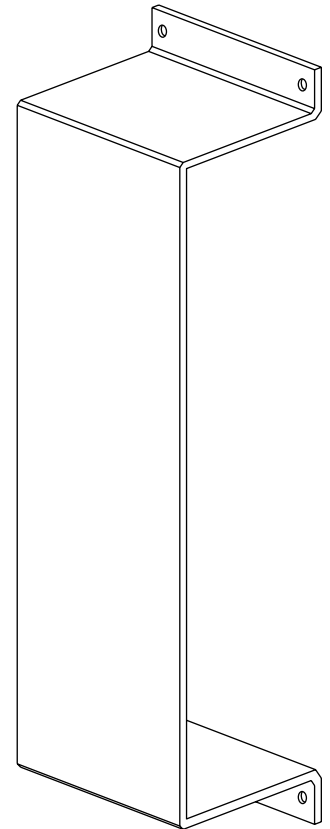

3-Dimensional View (Panel Only)

**Specifications**

Type of Valve	Instrumentation Ball Valves or Diaphragm Valves
End Connections	1/8" or 1/4" Compression
Type of Gas	All (Including Corrosive Gases)
No. of Valves Available	1/8" Valves: Up to 6 1/4" Valves: Up to 3
Working Pressure	1000 psi Max.

**Key Features**

- Multiple Gas Service
- Inlet and outlet fittings can be located either on the top or at the bottom at the customer's request
- Inlet Pressure UP to 1000 psig
- Brass or stainless steel construction