



Protocol Station Bracket (PSB Series - Brass Construction or Stainless Steel Construction)

SPECIFICATION

Description

The PSB Series Protocol Station Brackets are designed for the convenient wall mounting of any pressure reducing regulators (regulators are selected separately from the protocol station bracket). Wall mounting of a regulator provides ease of use, prevents regulator damage and improves safety.

There are two selections to be made:

1) Pressure Regulator

Although any type of BeaconMedaes cylinder regulators can be mounted to the protocol stations, the typical regulator of choice for the protocol station is the Ultra High Purity Series. They are available in chrome-plated brass or in stainless steel. Both the optional 1/4-turn diaphragm valve and regulators come standard with Hastelloy diaphragms.

2) Protocol Station Features

The features of the protocol station have to be selected once the pressure regulator is chosen. The protocol station and the regulator selected will come mounted, tested and delivered as a single unit.

The PSB Series is available in brass, chrome-plated brass or stainless steel construction. They come complete with a 3- foot long flexible hose. The cylinder connection in the flexible hose has an integral check valve which minimizes the amount of airborne contaminants entering the gas delivery system during cylinder changeouts.

Technical Specification	
Maximum Inlet Pressure	3000 psi(g) [207 bar(g)]
Hose Length	36 inches [915 mm]
Alarm Set Points	Brass Units 235 psi(g) [16.2 bar(g)] on fall Stainless Steel Units 300 psi(g) [20.7 bar(g)] on fall
Optional Alarm Box	120 VAC Receptacle 50-60 Hz

Vent Valve Option

The vent valve option is a set of two valves: a block valve and a vent valve. The vent valve is used to vent airborne contaminants out of a gas delivery system during a cylinder changeout. The block valve keeps contaminants from reaching the pressure reducing regulator.

Optional Alarm Box

The alarm box monitors the gas cylinder pressure. The alarm is triggered when the pressure reaches a pre- determined set point:

- The LED turns from green to red
- The internal buzzer is actuated
- The output signal relay is energized

The silence pushbutton kills the audible alarm but does not cancel the red LED and the output relay remains energized. The standard alarm box is for indoor use only. The NEMA 3R enclosure can be installed outdoors.

Standard Configuration

Model Shown

Regulator : UTC-580N-50-DVC-PRV

Protocol Station Bracket: PSB-580N-C-AB-SSHAG

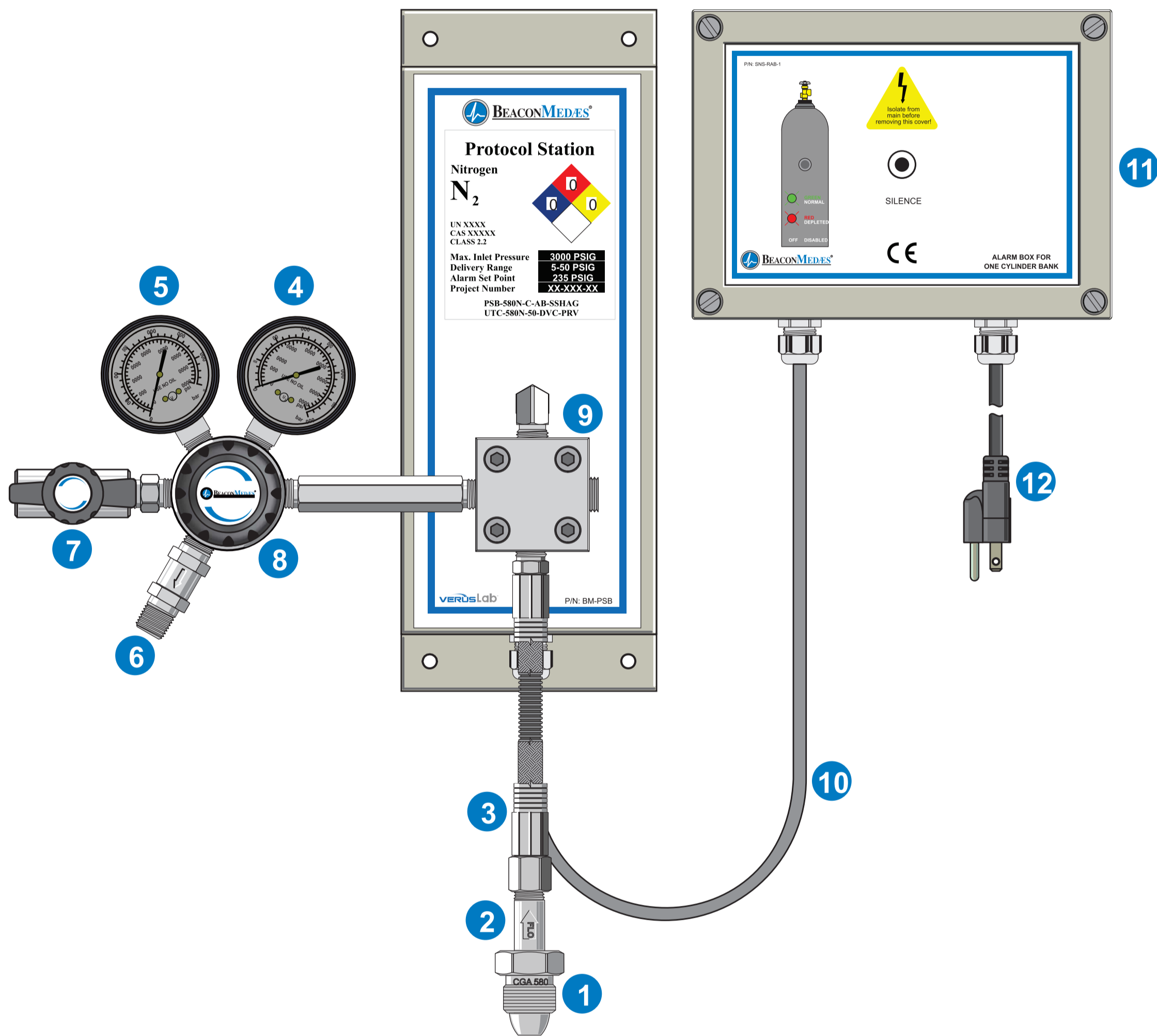

- 1 Cylinder Nut
- 2 Cylinder Nipple w/ Check Valve
- 3 Cylinder Lead 36-inch long
- 4 Inlet pressure Gauge
- 5 Delivery Pressure Gauge
- 6 Relief valve (1/4" M. NPT)

- 7 Optional Diaphragm Valve, 1/4-Turn
- 8 Pressure Regulator
- 9 Mounting Block
- 10 Alarm Box Cable
- 11 Optional Alarm Box
- 12 Power Cord 60-inch long

Vent Valve Option

Model Shown

Regulator : UTC-580N-145-DVC-PRV

Protocol Station Bracket: PSB-580N-C-AB-SSHAG-VV

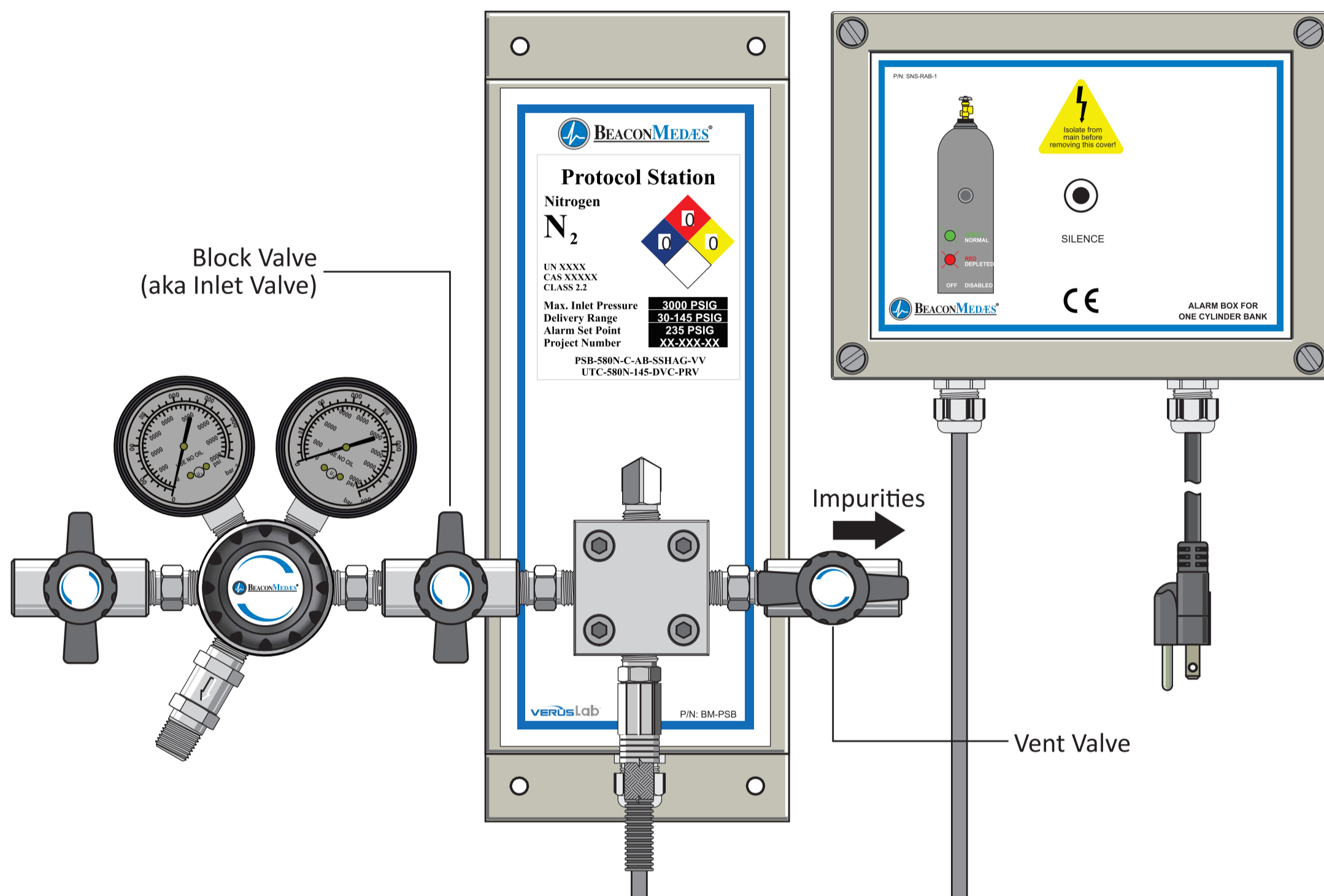

Mounting Panel Dimensions

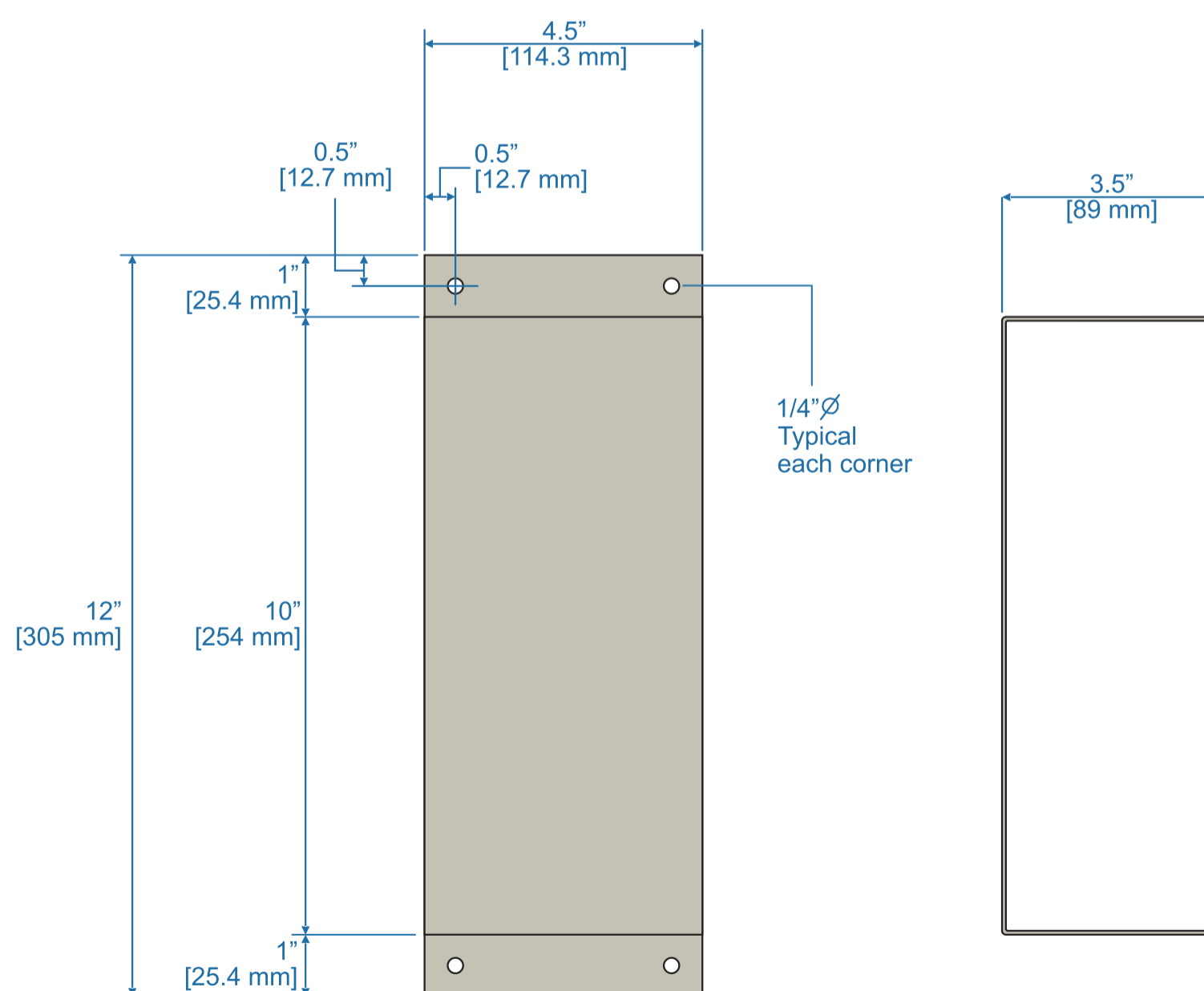

PSB - - - - - -

A B C D E F

BeaconMedaes PSB Series Model Number Chart			
Variable	Definition	Allowable Value	Description
A	Gas	346	Air
		580A	Argon
		320	Carbon Dioxide*
		580H	Helium
		350H	Hydrogen
		350M	Methane
		350P	P-10
		580N	Nitrogen
		590	Air [Synthetic]
		326	Nitrous Oxide*
		540	Oxygen
			Specify
B	Material	B	Brass
		C	Chrome-Plated Brass
		SS	Stainless Steel
C	Alarm Box	AB	with Alarm Box
		Leave blank	without Alarm Box
D	Cylinder Leads	TCH	Teflon Core Hose
		SSH	Stainless Steel Hose
		SSHAG	Stainless Steel Hose with Armor Guard
E	Option	VV	Vent Valve
		3R	NEMA 3R Alarm Box
F	Cylinder Connection	Leave Blank	CGA - United States Britain
		BS	BS341 - Great
		DIN	DIN 477 - Germany
		NEN	NEN 3268 - The Netherlands

*Nitrous oxide and carbon dioxide protocol stations shall be mounted with a heated, two-stage, brass regulator to prevent regulator freeze-up. The maximum flow of a protocol station mounted without a heated regulator is limited to 35 scfh.