



BEACONMEDAES®



Ensures **medical gas**
is consistently provided
to patients

Medical Gas Outlets



Your, outlet decision

Whether your medical gas outlets decision will be made to match existing or you're free to choose your outlets based on technology and up-to-date features, BeaconMedæ's is your source for the highest quality product measured in durability, reliability, and cost-effectiveness available anywhere.

1 Diamond® III/Gemini

- The pioneering Diamond® Series outlet.
- Available in Diamond® and D.I.S.S., wall and console versions.
- Familiar appearance, operation, parts and procedures.

2 Series B

Today's Standard

- Series B is the most common outlet frame in use today.
- Captured valve design prevents parts from falling on the floor during routine maintenance.
- All common non-interchangeable keyings, wall and console versions.
- Our Hook Plate features a retractable hook that organizes setup and takes the load off the outlets, ensuring costly gas leaks are minimized.
- Our Series B includes Biomaster, an additive that has been proven to inhibit bacterial growth.

(Disclaimer: Use of this product does not protect user from disease-bearing and food-borne pathogens.)

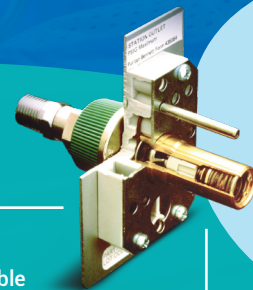

Series B's captured valve design prevents loss of parts during servicing

Fully compatible with third party adapters

Captured valve



Diamond III/Gemini Outlet



Series B Outlet

Your optimal solution for medical gas outlets

BeaconMedæ's can provide any of the major keying styles in the most desired outlet frames:

	DISS	Pin Index	Latch Index	Geometric	AS 2896
Series B	✓	✓	✓	✓	
DiamondCare	✓	✓	✓	✓	✓
Diamond III /Gemini	✓	✓			
Chemetype	✓		✓		



D.I.S.S.



Geometric Index (Puritan-Bennett®)

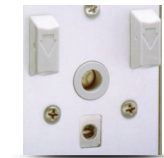

Latch Index (NCG®, Chemetron®)



Pin Index (Ohio, Ohmeda®, Medæ's®, Diamond®)

Matching your outlet is our goal

Whatever outlet system you have, you need new outlets and parts that are absolutely identical to your current system. It's our goal to ensure that the parts you buy are identical and reliably interchangeable with the parts you have.

3 DiamondCare®

Clean styling, Help during installation and Simplified maintenance

- DiamondCare's replaceable barrel design on quick connect outlets provides all the front body parts in one, easy-to-install, factory assembled barrel.
- Keying disks and labels are gas-specific and boldly color-coded.
- DiamondCare includes a unique transparent dust shield that protects the rough-in but also permits system purging at the outlet without the use of any special tool.
- Our DiamondCare includes Biomaster, an additive that has been proven to inhibit bacterial growth. (Disclaimer: Use of this product does not protect user from disease-bearing and food-borne pathogens.)



DiamondCare® Outlet

4 Chemetype Series 4 and 5

Exact match to 500/560 and 400 /460 Series outlets from Chemetron

- 100% dimensional equivalence for complete interchangeability.
- Second source for your favorite outlets and parts with the significant extra benefit of becoming part of the BeaconMedæ's family for your service and support.



Chemetype Outlet



DiamondCare's twist out barrel makes for easy repair or maintenance

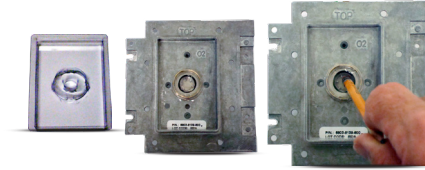

The DiamondCare Dust Shield comes installed in every rough in. Just push in and it holds the check open for purging. No special tool to buy, nothing to misplace.

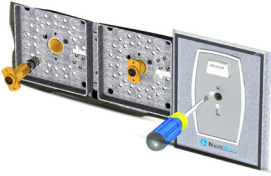

Chemetype Outlet installation showing the Rough-in, Barrel and Finish Assembly

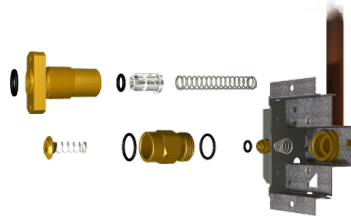

Chemetype Console Parts Explosion - the complete outlets and all parts are in every respect interchangeable with 400 and 500 series outlets you already have installed.

All trademarks are the property of their respective owners

BeaconMedæ's quality

BeaconMedæ's outlets are UL listed, CSA certified and are fully compliant with the latest edition of NFPA 99. In addition, all outlets are cleaned for oxygen use.

BeaconMedæ's observes the most extensive test procedure of any outlet manufacturer in the world. For instance, our Series B outlets are 100% tested for flow, leaks, connector attachment and indexing (both outlet to adapter and rough in to latch valve) prior to shipping. This process is performed on computer controlled, high precision test stands, custom built for this unique process, unlike other manufacturers where this same testing, if it is performed at all, must be performed manually.

Parts and support from BeaconMedæ's

Support for older outlets

- Diamond® II to Diamond®/D.I.S.S. III conversion kits.
- Diamond® I and D.I.S.S. I service parts.
- Series B upgrades from older P-B outlets.
- Diamond® II/III to DiamondCare® upgrades.

BeaconMedæ's maintains the largest field service force dedicated to medical gas systems in the world. Our service technicians are available to help you with any medical gas outlet maintenance or repair need - even if we were not the original manufacturer.

We also have a very knowledgeable technical service department who can assist customers in resolving problems. Engineering support, as well as other factory resources, is available to assist in resolving problems quickly. Whether you contact your local service specialist directly or contact our after hours emergency phone service, BeaconMedæ's will respond to your needs around the clock.



Life is in the details.®

